



2,339

SQUARE FEET

4

BEDROOMS

2.5

BATHROOMS

\$573,950

SALES PRICE

EXPANSIVE PATIO →

MAIN LEVEL

FIREPLACE →

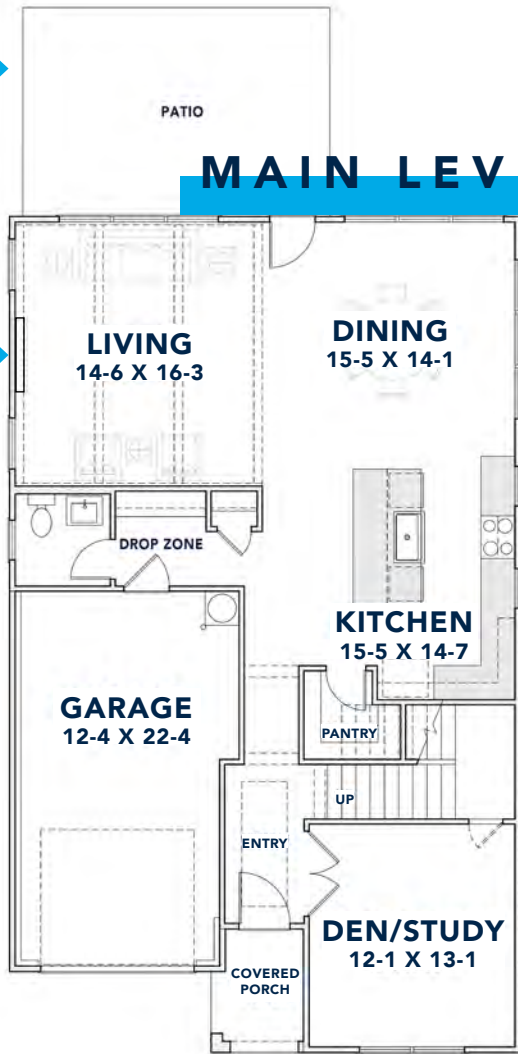

SECOND LEVEL

WALK-IN CLOSET →



← LAUNDRY UPSTAIRS

WHERE YOUR STORY
BEGINS

Located in the cozy Oakhurst neighborhood, just 10 minutes from Uptown, 5220 Lynnville Ave. features 2,339 square feet with luxury details including quartz countertops, gold finishes, one-car garage, a back patio, spacious backyard with privacy fencing and Nest thermostat, video doorbell and keyless entry.

Floorplan dimensions are subject to change.

LUXURY IN THE DETAILS

FINISHING TOUCHES

- Crown moulding through first floor and second floor hallway
- 10-foot ceilings on first floor; 9-foot on second floor



DREAM KITCHEN

- Caesarstone Frosty Carrina quartz countertops
- New Yorker 3x12 Bright White backsplash
- Shaker-style solid wood cabinets
- GE stainless steel gas range with hood
- Whirlpool stainless steel dishwasher with hidden controls

PERSONAL ESCAPE

- Soaking tub in owner and guest baths
- 42-inch direct vent fireplace
- Your own home office with a door
- Spacious backyard with privacy fence

IMMACULATE SPACES

- Mohawk 5-inch plank hardwood floors and carpet in bedrooms
- Drop zone at rear entry
- Designer light fixtures throughout



Design selections are subject to change.

AT THE CENTER OF EVERYTHING

Just a 10-minute drive from Uptown, the Oakhurst neighborhood off Monroe Road features seven distinctive homes along the quiet residential street of Lynnville Avenue. Walk to pick up a sandwich from Common Market Oakwold, grab fajitas from Las Margaritas, or take a class at NoDa Yoga, all less than a mile away.



E INDEPENDENCE BLVD

UNAKA AVE

DUDLEY DR

BUENA VISTA AVE

GWYNEE AVE



LYNNVILLE AVE

LANIER RD

N SHARON AMITY RD

MONROE RD

DORIS AVE

ELDER AVE

5220

Lynnville Ave

Plot plan is subject to change.

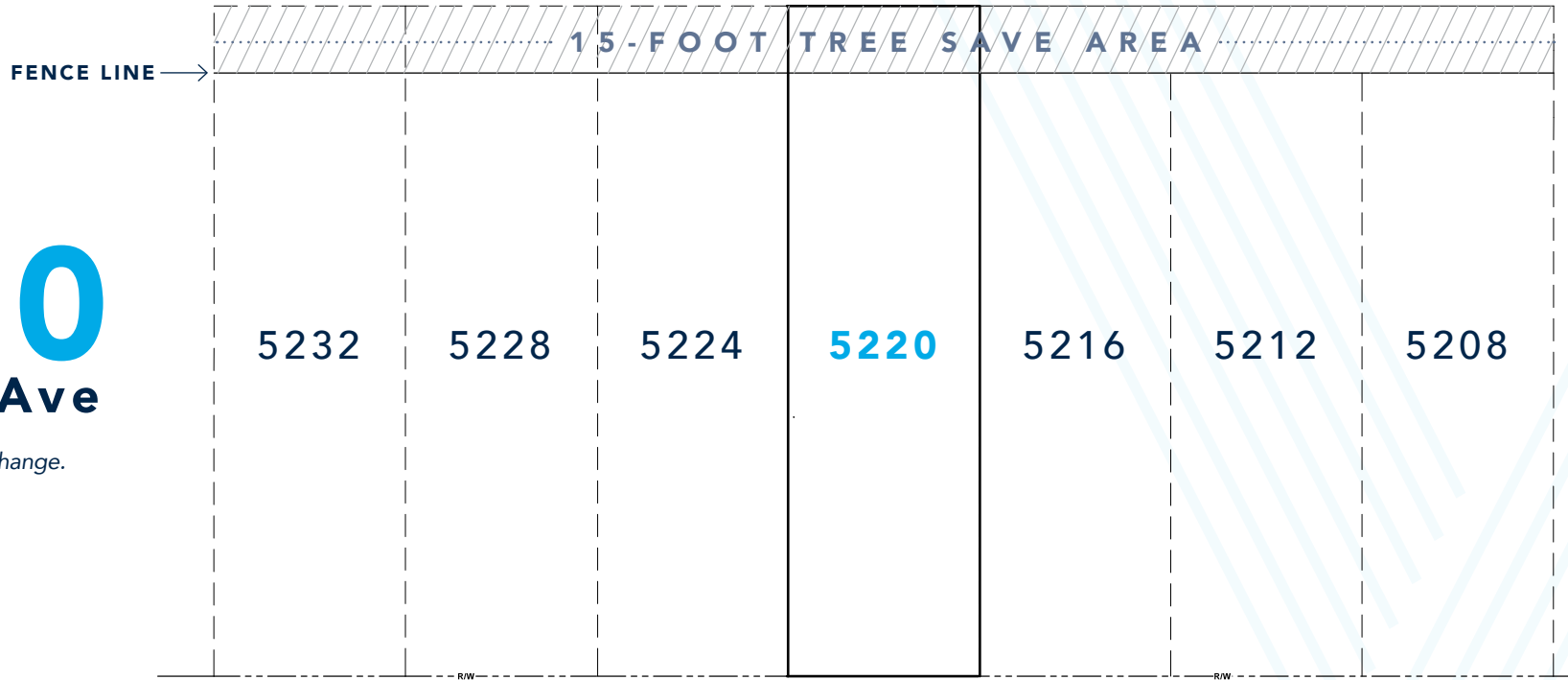

UNIT	HEATED SF	FLOORPLAN	DESIGN PACKAGE	BED	BATH	GARAGE	OUTDOOR SPACE	PRICE
5232 Lynnville Ave	2,339	Fir 2	Chrome	4	2.5	1-Car	12x18 Back Patio	\$ 571,750
5228 Lynnville Ave	2,356	Fir 3	Black	4	2.5	1-Car	12x18 Back Patio	SOLD
5224 Lynnville Ave	2,330	Fir 1	Chrome	4	2.5	1-Car	12x18 Back Patio	SOLD
5220 Lynnville Ave	2,339	Fir 2	Gold	4	2.5	1-Car	12x18 Back Patio	\$ 573,950
5216 Lynnville Ave	2,356	Fir 3	Chrome	4	2.5	1-Car	12x18 Back Patio	\$ 574,750
5212 Lynnville Ave	2,330	Fir 1	Black	4	2.5	1-Car	12x18 Back Patio	\$ 583,750
5208 Lynnville Ave	2,339	Fir 2	Gold	4	2.5	1-Car	12x18 Back Patio	\$ 588,450