



**2,339**

SQUARE FEET

**4**

BEDROOMS

**2.5**

BATHROOMS

**SOLD**

SALES PRICE

EXPANSIVE PATIO →

## MAIN LEVEL

FIREPLACE →

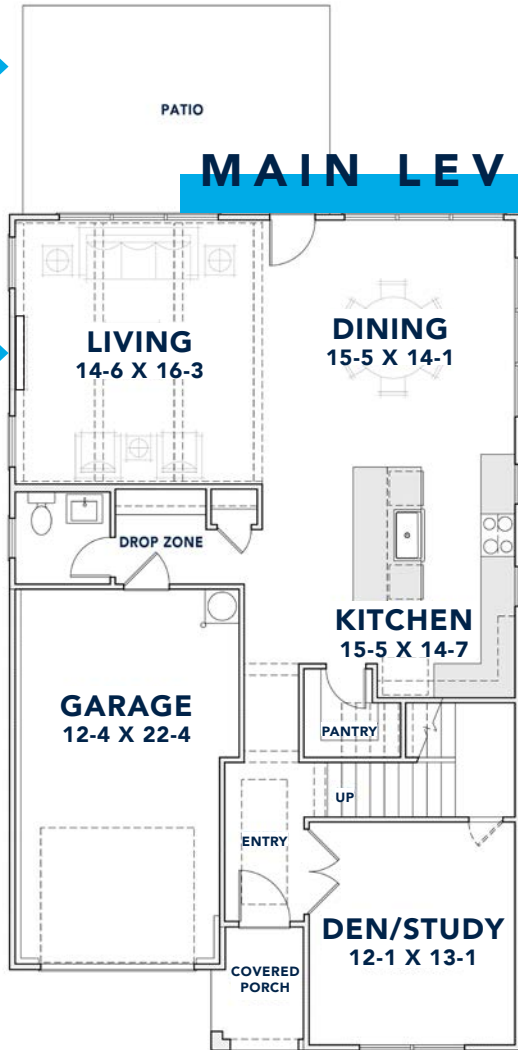

## SECOND LEVEL

WALK-IN CLOSET →



← LAUNDRY UPSTAIRS

WHERE YOUR STORY  
**BEGINS**

Located in the cozy Oakhurst neighborhood, just 10 minutes from Uptown, 5220 Lynnville Ave. features 2,339 square feet with luxury details including quartz countertops, gold finishes, one-car garage, a back patio, spacious backyard with privacy fencing and Nest thermostat, video doorbell and keyless entry.

*Floorplan dimensions are subject to change.*

# LUXURY IN THE DETAILS

## FINISHING TOUCHES

- Crown moulding through first floor and second floor hallway
- 10-foot ceilings on first floor; 9-foot on second floor



## DREAM KITCHEN

- Caesarstone Frosty Carrina quartz countertops
- New Yorker 3x12 Bright White backsplash
- Shaker-style solid wood cabinets
- GE stainless steel gas range with hood
- Whirlpool stainless steel dishwasher with hidden controls

## PERSONAL ESCAPE

- Soaking tub in owner and guest baths
- 42-inch direct vent fireplace
- Your own home office with a door
- Spacious backyard with privacy fence



## IMMACULATE SPACES

- Mohawk 5-inch plank hardwood floors and carpet in bedrooms
- Drop zone at rear entry
- Designer light fixtures throughout



*Design selections are subject to change.*

# LUXURY IN THE DETAILS

## DREAM KITCHEN



Shaker-style solid wood cabinets

GE stainless steel gas range with hood



Microwave Drawer



Whirlpool stainless steel dishwasher with hidden controls



30" Gas Range & Hood



Island Pendants



Faucet  
Air Switch  
Sink



Cabinet Hardware



New Yorker 3x12 Bright White Backsplash

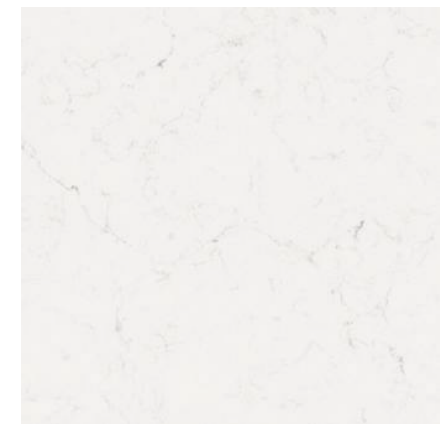

Caesarstone Frosty Carrina Quartz Countertops

Design selections are subject to change.

# AT THE CENTER OF EVERYTHING

Just a 10-minute drive from Uptown, the Oakhurst neighborhood off Monroe Road features seven distinctive homes along the quiet residential street of Lynnville Avenue. Walk to pick up a sandwich from Common Market Oakwold, grab fajitas from Las Margaritas, or take a class at NoDa Yoga, all less than a mile away.



E INDEPENDENCE BLVD

UNAKA AVE

LAS MARGARITAS



DUDLEY DR

BUENA VISTA AVE

GWYNEE AVE

LANIER RD



LYNNVILLE AVE

MONROE RD

DORIS AVE

ELDER AVE

N SHARON AMITY RD

# 5220

## Lynnville Ave

Plot plan is subject to change.

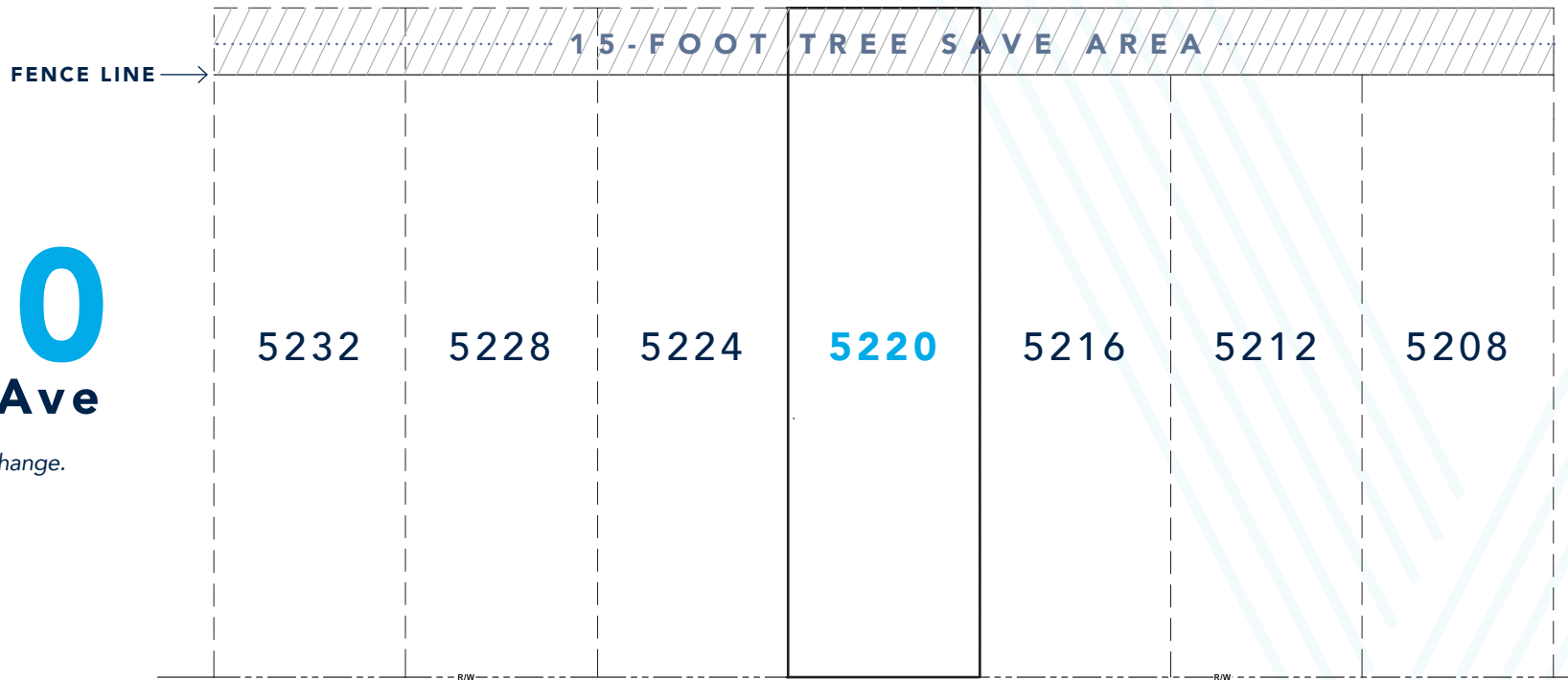

UNIT	HEATED SF	FLOORPLAN	DESIGN PACKAGE	BED	BATH	GARAGE	OUTDOOR SPACE	PRICE
5232 Lynnville Ave	2,339	Fir 2	Chrome	4	2.5	1-Car	12x18 Back Patio	SOLD
5228 Lynnville Ave	2,356	Fir 3	Black	4	2.5	1-Car	12x18 Back Patio	SOLD
5224 Lynnville Ave	2,330	Fir 1	Chrome	4	2.5	1-Car	12x18 Back Patio	SOLD
5220 Lynnville Ave	2,339	Fir 2	Gold	4	2.5	1-Car	12x18 Back Patio	SOLD
5216 Lynnville Ave	2,356	Fir 3	Chrome	4	2.5	1-Car	12x18 Back Patio	SOLD
5212 Lynnville Ave	2,330	Fir 1	Black	4	2.5	1-Car	12x18 Back Patio	\$ 614,650
5208 Lynnville Ave	2,339	Fir 2	Gold	4	2.5	1-Car	12x18 Back Patio	SOLD